

HH020

Payload 20 Kg

Installation method		Application	
Floor	●	Spot welding	●
Ceiling	●	Arc welding	●
Wall surface	●	Handling	●
		Assembly	●
		Sealing	●
		Painting	●

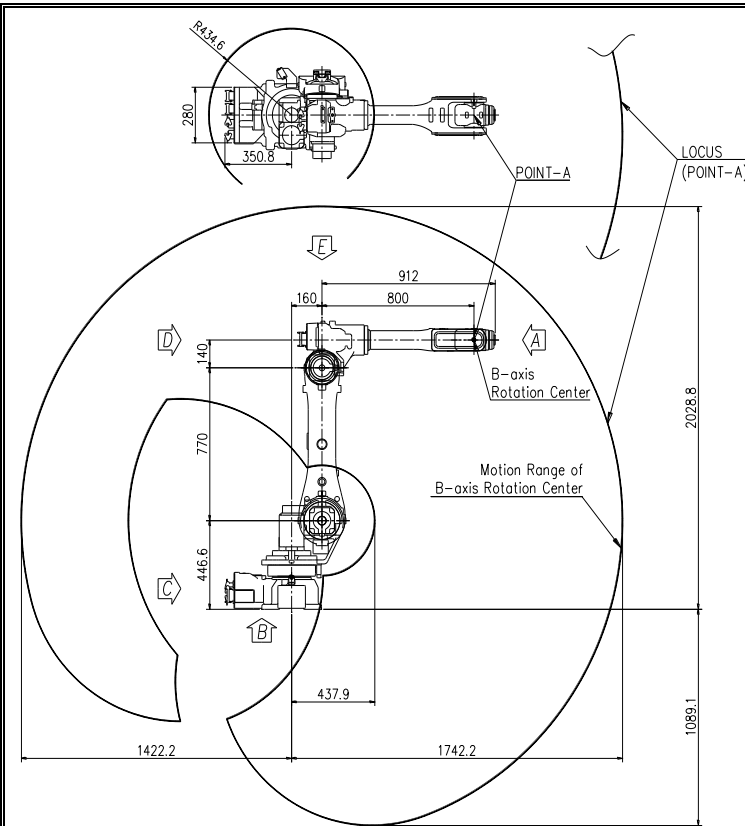

Item	Specification		
Robot model	HH020		
Payload	20 Kg		
Structure	Articulated		
Degree of freedom	6 axes		
Drive system	AC SERVO MOTOR		
Max. working envelope	A	S Swivel	$\pm 3.229 \text{ rad } (\pm 185^\circ)$
	r	H Horizontal	$+3.403 \sim -1.222 \text{ rad } (+195^\circ \sim -70^\circ)$
		V Vertical	$+3.141 \sim -1.396 \text{ rad } (+180^\circ \sim -80^\circ)$
		R2 Rotation 2	$\pm 3.403 \text{ rad } (\pm 195^\circ)$
	m	B Bending	$\pm 2.356 \text{ rad } (\pm 135^\circ)$
R1 Rotation 1		$\pm 6.283 \text{ rad } (\pm 360^\circ)$	
Max. working speed	A	S Swivel	$3.316 \text{ rad / s } (190^\circ / \text{s})$
	r	H Horizontal	$3.142 \text{ rad / s } (180^\circ / \text{s})$
		V Vertical	$3.316 \text{ rad / s } (190^\circ / \text{s})$
		R2 Rotation 2	$6.632 \text{ rad / s } (380^\circ / \text{s})$
	m	B Bending	$6.632 \text{ rad / s } (380^\circ / \text{s})$
R1 Rotation 1		$10.472 \text{ rad / s } (600^\circ / \text{s})$	
Wrist torque	R2 Rotation 2	$39.2 \text{ Nm } (4 \text{ Kgfm})$	
	B Bending	$39.2 \text{ Nm } (4 \text{ Kgfm})$	
	R1 Rotation 1	$19.6 \text{ Nm } (2 \text{ Kgfm})$	
Accuracy of position repeatability	$\pm 0.08 \text{ mm}$		
Ambient Temperature	$0 \sim 45^\circ \text{C } (273 \sim 318 \text{ K})$		
Robot's Weight	225 Kg		
Working envelope section area	6.07 m^2		

View A: Detailed drawing of the wrist attachment part

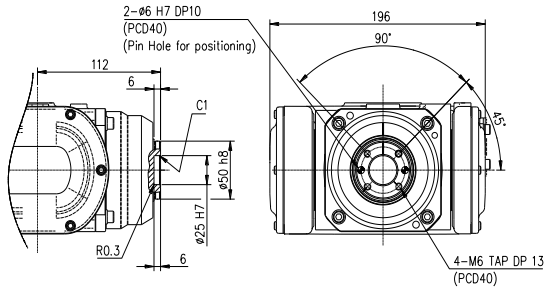

View B: Dimensional drawing for the floor installation of the body

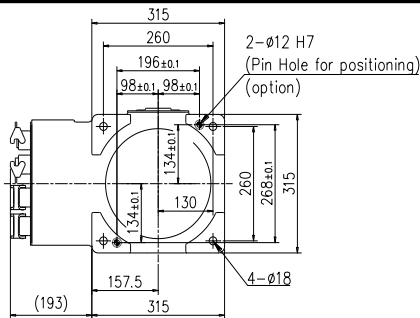

View C: Application cable connection part (Option)

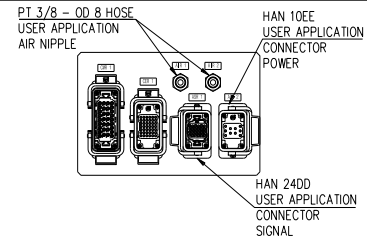

View D: Application cable connection part (Option)

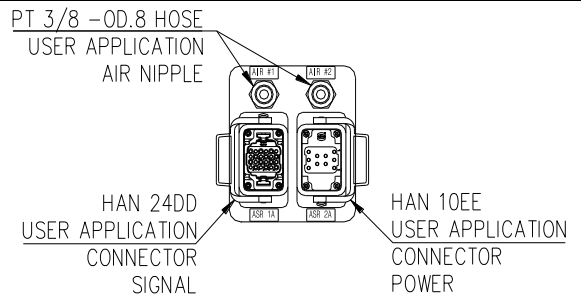

View E: Details of the application ancillary part attachment

Wrist-axis torque line diagram

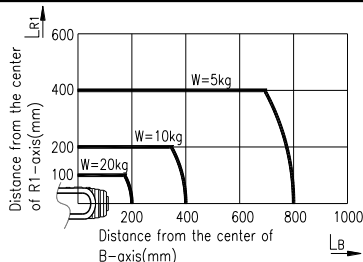

** For product improvement, some of the ratings, specifications, dimensions, etc. are subject to changes without notice.