

HH8

Installation method		Application	
Floor	●	Spot welding	
Ceiling	●	Arc welding	
Wall surface	●	Handling	●
		Assembly	
		Sealing	
		Painting	

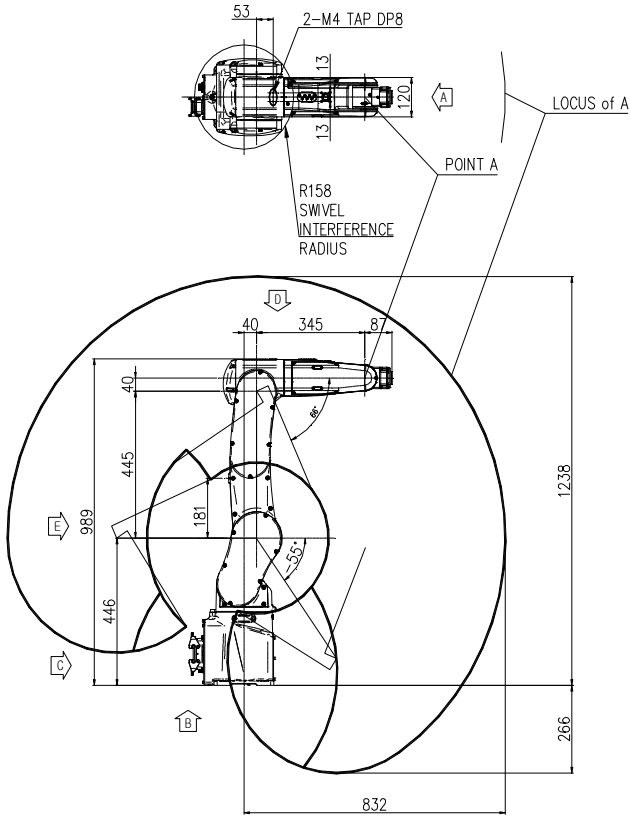

View A: Detailed drawing of the wrist attachment part

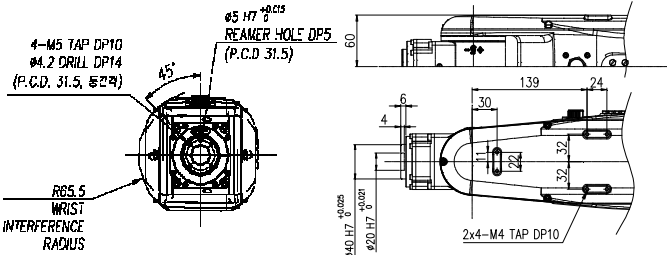

View B: Dimensional drawing for the floor installation of the body

View G: Application part mounting

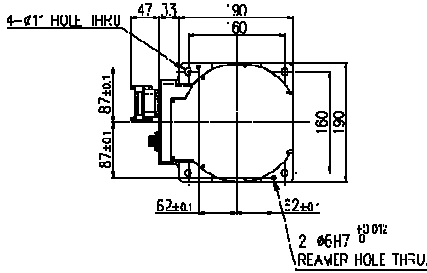

Wrist-axis torque line diagram

View E: Details of the application ancillary part

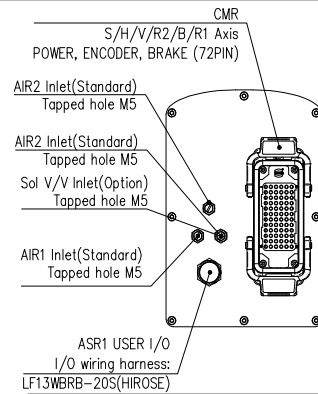
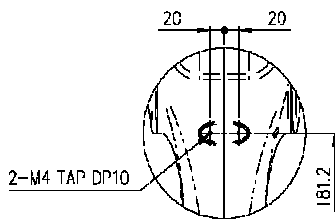
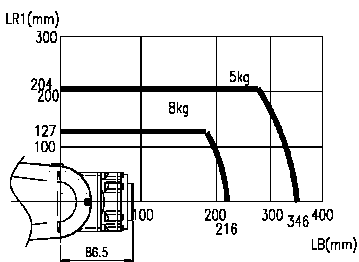

View D: Application cable connection part

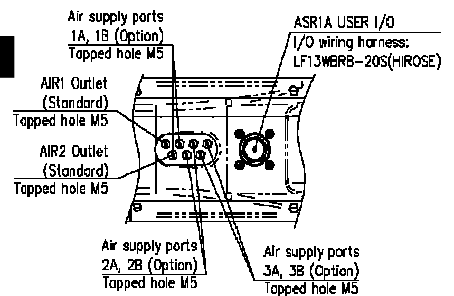

Item		Specification
Robot model		HH8
Payload		8 Kg
Structure		Articulated
Degree of freedom		6 axes
Drive system		AC SERVO MOTOR
Max. working envelope	Arm	A S Swivel ± 2.967 rad ($\pm 170^\circ$)
		H Horizontal 55°
		V Vertical $+3.71 \sim -1.22$ rad ($+213^\circ \sim -70^\circ$)
	Wrist	R2 Rotation 2 ± 3.316 rad ($\pm 190^\circ$)
		B Bending ± 2.356 rad ($\pm 135^\circ$)
		R1 Rotation 1 ± 6.283 rad ($\pm 360^\circ$)
Max. working speed	Arm	A S Swivel 7.941 rad / s (455° / s)
		H Horizontal 6.719 rad / s (385° / s)
		V Vertical 9.075 rad / s (520° / s)
	Wrist	R2 Rotation 2 9.599 rad / s (550° / s)
		B Bending 9.599 rad / s (550° / s)
		R1 Rotation 1 17.453 rad / s (1000° / s)
Wrist torque	R2 Rotation 2 17 N.m (1.73 Kgf.m)	
	B Bending 17 N.m (1.73 Kgf.m)	
	R1 Rotation 1 10 N.m (1.02 Kgf.m)	
Accuracy of position repeatability		± 0.02 mm
Ambient Temperature		$0 \sim 45^\circ\text{C}$ (273 ~ 318 K)
Robot's Weight		41 Kg
Working envelope section area		1.46 m ²

***) When the optional limit switch is attached, the action range of the main axis will be limited (see the manual).**

View C: Application cable connection part

**** For product improvement, some of the ratings, specifications, dimensions, etc. are subject to changes without notice**