

# HS260

## Payload 260Kgf

Installation method		Application	
Floor	●	Spot welding	●
Ceiling		Arc welding	
Wall surface		Handling	●
		Assembly	
		Sealing	●
		Painting	

Item		Specification	
Robot model		HS260	
Payload		260 Kg	
Structure		Articulated	
Degree of freedom		6 axes	
Drive system		AC SERVO MOTOR	
Max. working envelope	Arm	S Swivel	$\pm 3.141$ rad ( $\pm 180^\circ$ )
		H Horizontal	$+2.705 \sim +0.174$ rad ( $+155^\circ \sim +10^\circ$ )
	V Vertical	$+3.316 \sim -1.396$ rad ( $+190^\circ \sim -80^\circ$ )	
	Wrist	R2 Rotation 2	$\pm 6.283$ rad ( $\pm 360^\circ$ )
		B Bending	$\pm 2.094$ rad ( $\pm 128^\circ$ )
R1 Rotation 1		$\pm 6.283$ rad ( $\pm 360^\circ$ )	
Max. working speed	Arm	S Swivel	1.919 rad / s ( $110^\circ / s$ )
		H Horizontal	1.850 rad / s ( $106^\circ / s$ )
	V Vertical	1.920 rad / s ( $110^\circ / s$ )	
	Wrist	R2 Rotation 2	2.443 rad / s ( $140^\circ / s$ )
		B Bending	2.443 rad / s ( $140^\circ / s$ )
R1 Rotation 1		3.665 rad / s ( $210^\circ / s$ )	
Wrist torque	R2 Rotation 2	1,618 Nm (165 kgfm)	
	B Bending	1,618 Nm (165 kgfm)	
	R1 Rotation 1	794 Nm (81 kgfm)	
Accuracy of position repeatability		$\pm 0.05$ mm	
Ambient Temperature		$0 \sim 45^\circ \text{C}$ ( $273 \sim 318$ K)	
Robot's Weight		1,250 Kg	
Working envelope section area		8.92 m <sup>2</sup>	

\* When the optional limit switch is attached, the action range of the main axis will be limited (see the manual)

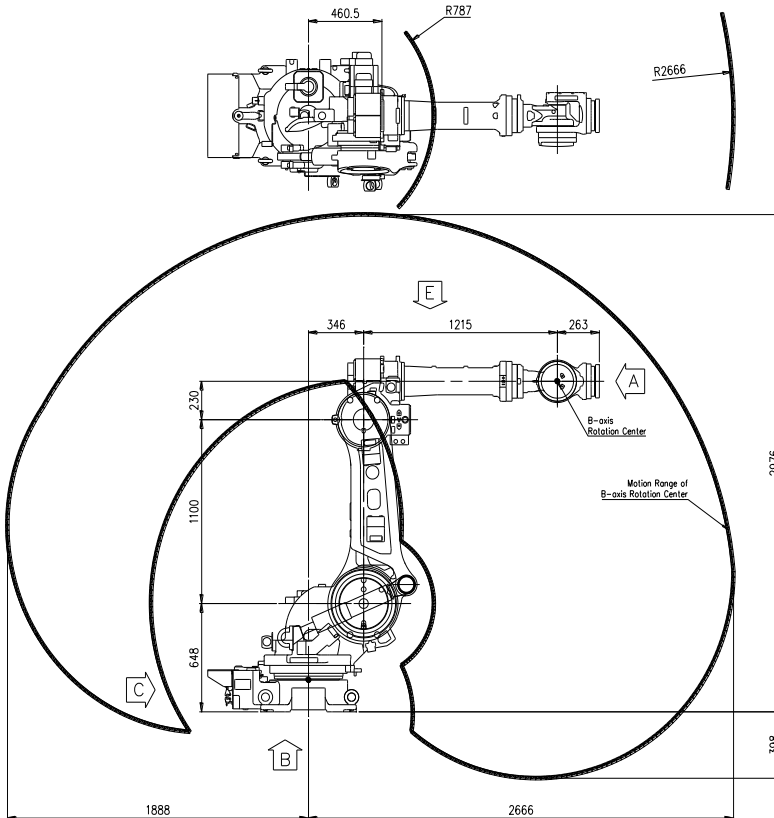

View A: Detailed drawing of the wrist attachment part

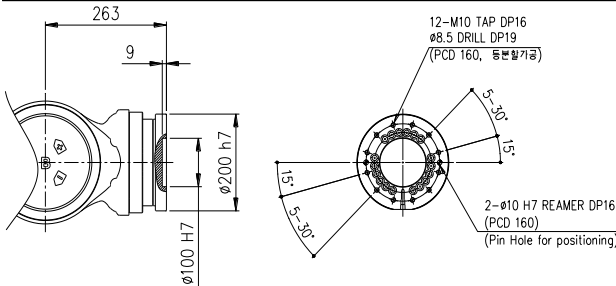

View B: Dimensional drawing for the floor installation of the body

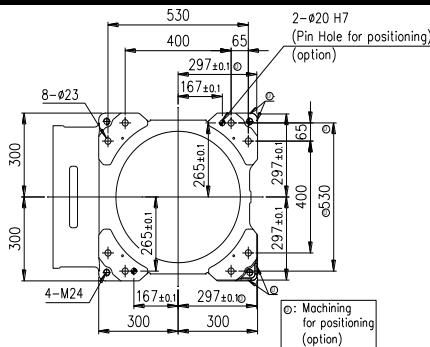

View C: Application cable connection part

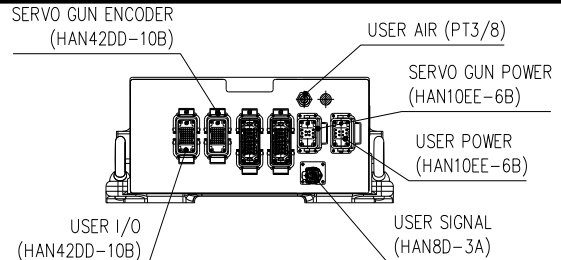

View D: Application cable connection part

### Wrist-axis torque line diagram

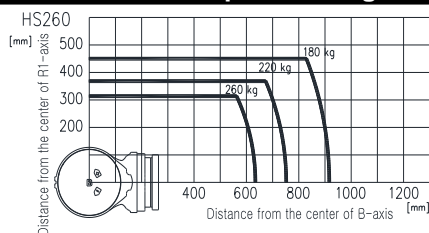

View E: Details of the application ancillary part attachment

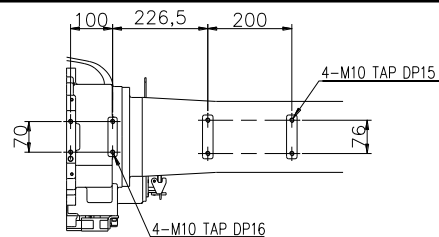

\*\* For product improvement, some of the ratings, specifications, dimensions, etc. are subject to changes without notice.