

# Medical and Pharmaceutical Robot VS-050S2 Series

Contributes to automation of medical product/device manufacturing and drug preparation



Maximum reach	520mm
Maximum payload	4kg
Cycle time	0.35 sec

## Resistant to sterile environments

Robot for use in sterilized/clean environments that employ H<sub>2</sub>O<sub>2</sub> gas 35% density(dry/wet), UV exposure, etc.

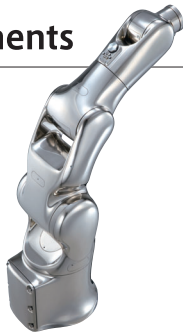

## Resists Contamination

The smooth surface prevents adherence of dust and dirt. The robot arm is constructed without external screws to maintain a high sanitation level.

Cleanness: ISO Class 5  
Protection level: Wrist IP67, Unit IP65



## Authentication

- Design compliant with GMP\* (product management and quality control standards) \* GMP Grade A
- cUL certified product (UL standard/Canada CSA standard) also available
- Hygiene proven through in testing by the Fraunhofer Institute (Report No. DE 1409-725)



## Isolation (Suitability for sealed environments)

Cables and connector panels are positioned on the bottom for installation in sealed and quarantine environments.



## Examples of Applications

### Automation of cell culture

- Robots reproduce the movements of skilled workers accurately to realize the automation of high-quality cell culture without variation in quality caused by multiple workers.
- Use of robots prevents contamination by human workers and eliminates the possibility of workers' exposure to hazards to realize a clean and safe system.
- Human workers' manipulations of general-purpose apparatus, such as pipetting and cap opening, can be reproduced accurately.

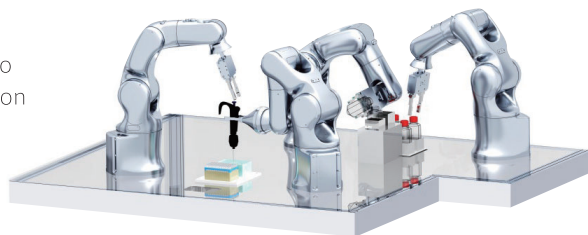

Scan for a video of an automated cell culture system



## Dimensions / Motion range

### Standard flange

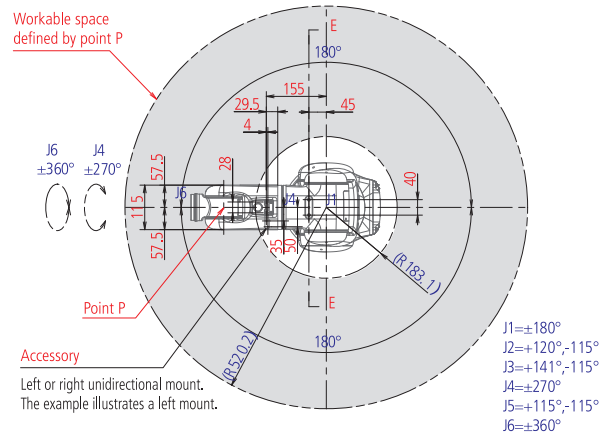
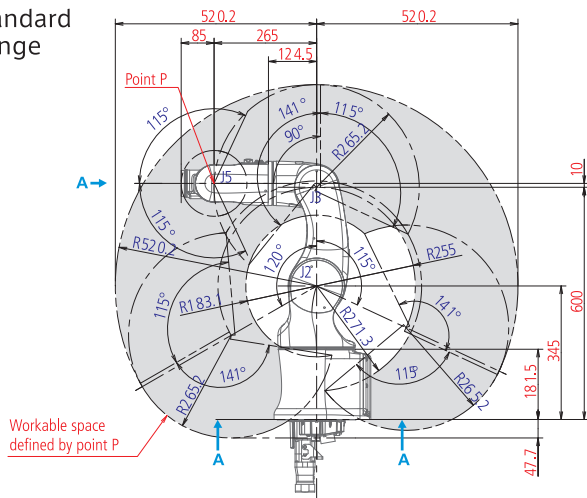

## Specifications

Item	Specifications
Model	VS-050S2
Axes	6
Position detection method	Absolute encoder
Drive motor / brake	All-axis AC servo motor, all-axis brake provided
Total arm length (1st arm + 2nd arm)	520 (255+265) mm
Maximum motion area (Point P)	520mm
Minimum motion radius (Point P)	183.5mm
Motion range	J1 (1st axis) ±180° (*3) J2 (2nd axis) +120°, -115° J3 (3rd axis) +141°, -115° J4 (4th axis) ±270° J5 (5th axis) ±115° (*4) J6 (6th axis) ±360°
Maximum payload	4kg
Maximum joint speed	J1 425deg/sec J2 283.33deg/sec J3 309.35deg/sec J4 425deg/sec J5 272.96deg/sec J6 680deg/sec
Cycle time (*1)	0.35sec
Position repeatability (at the center of end-effector mounting face) (*2)	±0.02mm
Maximum allowable moment of inertia	J4, J5 0.2kgm <sup>2</sup> J6 0.05kgm <sup>2</sup>
Maximum allowable moment	J4, J5 6.66Nm J6 3.13Nm
Signal line/air piping solenoid valve (option)	Signal line 10-core (*5, 6) Air piping solenoid valve Solenoid valve (2- position, double-solenoid) x 2
Electric gripper connection flange specification-A (option)	25-core (17 + 8) (*6)
Air source	Operating pressure 0.20~0.39MPa Maximum allowable pressure 0.49MPa
Noise (A-weighted equivalent continuous sound pressure level)	65 dB or lower
Environmental resistance	Hydrogen peroxide environment 35% Hydrogen peroxide steam (dry/wet) Protection level Wrist: IP67, Unit: IP65 Cleanness ISO Class 5
Weight	Approx. 34 kg

■ Detailed drawing of end-effector mounting face (Standard Flange) (View A)

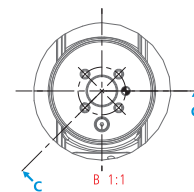

■ Detailed drawing of base mounting face (Top view)

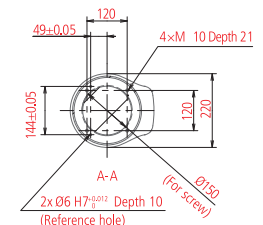

## Options

### Electric gripper connection flange specification-A

Internal mount with a gripper cable up to the flange. Suitable for clean environments, eliminates interference with peripherals



### External mount battery

Optional external mount battery for improved maintainability and battery replacement



\*1: Time required for a robot to move 1 kg payload between two points 300 mm apart at a height of 25 mm  
\*2: Position repeatability is the precision at constant ambient temperature  
\*3: Motion range is limited when mounted to a wall. Inquire for details.  
\*4: When electric gripper connection flange specification-A is selected, the J5 motion range is +110, -102.  
\*5: This wire (proximity sensor wire and other signal wires) has 4 cores if electric gripper connection flange specification-A is also selected.  
\*6: Allowable current is limited.

DENSO Products and Services Americas, Inc.  
3900 Via Oro Avenue, Long Beach, California, 90810, U.S.A.  
Phone : +1-888-476-2689 FAX : +1-310-952-7502

DENSO KOREA CORPORATION  
131, Seonggogae-ro, Uiwang-si, Gyeonggi-do, Korea 437-120  
Phone : +82-31-340-1783 FAX : +82-31-8033-7213

DENSO TAIWAN CORP.  
No.525 Sec.2, Mei Su Road, Jui Ping Li, Yang-Mei Town, Taoyuan Hsien, Taiwan  
Phone : +886 3-482-8001 FAX : +886 3-482-8003

DENSO EUROPE B. V. DENSO Robotics Europe  
Waldeckerstrasse 9 D-64546 Moerfelden-Walldorf, Germany  
Phone : +49-6105-27-35-150 FAX : +49-6105-27-35-180

DENSO (CHINA) INVESTMENT CO., LTD.  
No.35 Yuandian Road, Minhang District, Shanghai, CHINA 201108  
Phone : +86-21-2350-0093 FAX : +86-21-2350-0179

DENSO SALES (THAILAND) CO.,LTD.  
888 Moo 1, Bangna-Trad Rd. Km 27.5, T.Bangbor, A.Bangbor, Samutprakarn, 10560, Thailand  
Phone : +66-2-315-9500 FAX : +66-2-315-9556

