

# HX400

**Payload 400Kgf**

Installation method	
Floor	●
Ceiling	
Wall surface	

Application	
Spot welding	●
Arc welding	
Handling	●
Assembly	
Sealing	●
Painting	

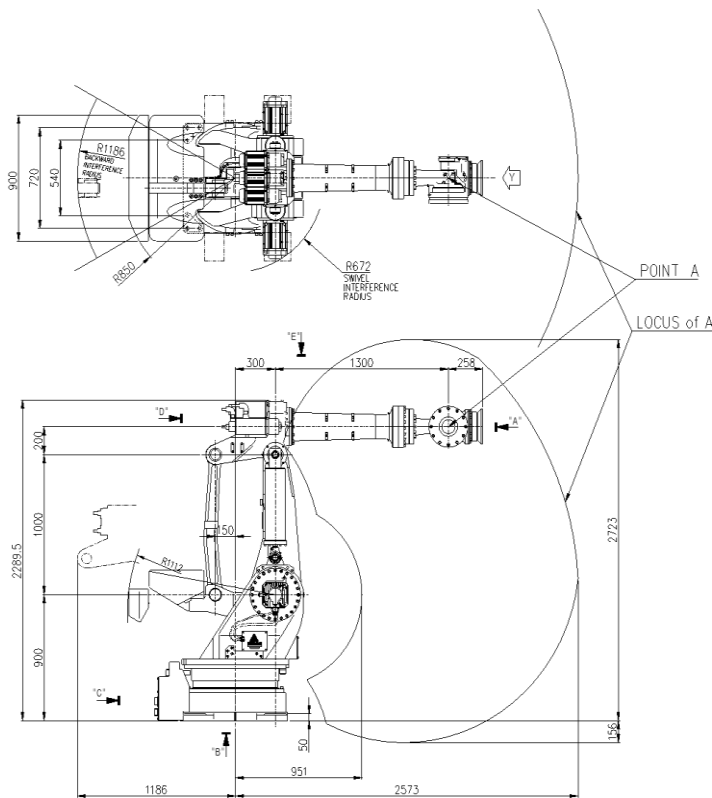

Item	Specification		
Robot model	HX400		
Payload	400Kg		
Structure	Articulated		
Degree of freedom	6 axes		
Drive system	AC SERVO MOTOR		
Max. working envelope	A r m	S	±3.142 rad (±180°)
		H	+2.879 ~ +0.261rad (+165° ~ +15°)
		V	+1.047 ~ -1.221rad (+60° ~ -70°)
	Wrist	R2	±6.283 rad (±360°)
		B	±2.094 rad (±120°)
Max. working speed	A r m	S	1.658 rad / s (95° / s)
		H	1.658 rad / s (95° / s)
		V	1.658 rad / s (95° / s)
	Wrist	R2	1.745 rad / s (100° / s)
		B	1.745 rad / s (100° / s)
Wrist torque	R2	1960 N·m (200Kgf·m)	
	B	1960 N·m (200Kgf·m)	
	R1	823 N·m (84Kgf·m)	
Accuracy of position repeatability	±0.08 mm		
Ambient Temperature	0 ~ 45°C (273 ~ 318 K)		
Robot's Weight	2,620 Kg		
Working envelope section area	4.519 m <sup>2</sup>		

**View A: Detailed drawing of the wrist attachment part**

**View C: Application cable connection part**

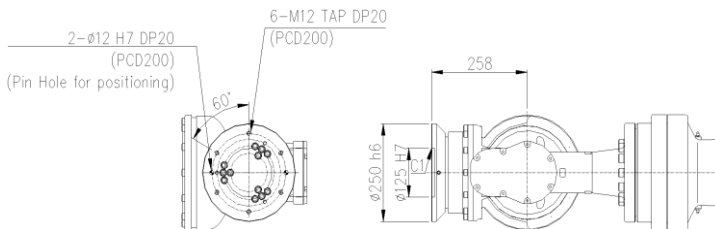

**View B: Dimensional drawing for the floor installation of the body**

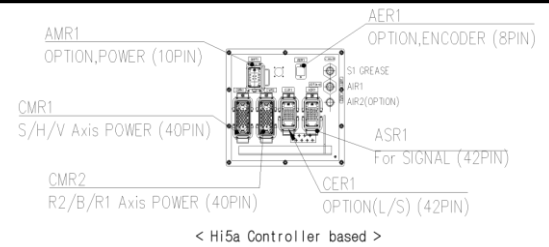

**View D: Application cable connection part**

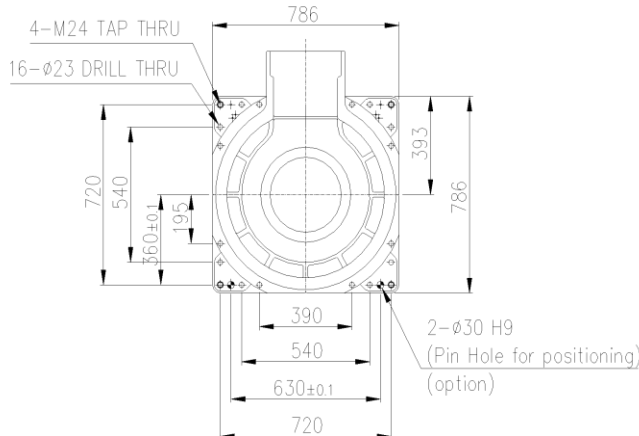

**View E: Details of the application ancillary part attachment**

\*\* For product improvement, some of the ratings, specifications, dimensions, etc. are subject to changes without notice.